



STRATA

SUPERIOR WELDING PRODUCTS

• ADVANCEARC 165 •

MMA (STICK) WELDER

The ADVANCEARC Series of MMA (Stick) welders offer the latest IGBT and PFC (Power Factor Correction) technology for smart operators. Increased reliability and performance for harsh and demanding conditions. Equipped with multi-voltage technology, giving you piece of mind when operating on generators or long extension cords.



- IGBT Inverter technology for smooth & stable welding output
- Active PFC technology for increased duty cycle and energy efficiency
- Increased safety with MMA VRD protection mode
- Will operate with wide range of input voltage, including long extension leads
- Industrial IP23 casing with front panel protection resists damage, moisture and corrosion
- Microprocessor control system with superior and dynamic arc characteristics
- Lightweight & compact design for portable applications
- Extreme stress tested in production up to 440V, ensuring rugged reliability
- Adjustable arc force and hot start enable good control and ease of use when MMA welding
- Lift TIG welding operation for precision in aesthetically important welding jobs (torch optional)
- Accurate pre-setting and feedback of welding parameters & output with digital current display meter
- Durable and reliable with high quality & over specified electronic components
- Intelligent protection system with temperature, voltage and current sensors for increased reliability and safety
- Designed to work with generator power supply with protection from power surges
- Multi PCB construction is economical to service and repair compared to single PCB design
- Accessories include 4m MMA lead with heavy duty twist lock electrode holder and 3m earth lead with heavy duty earth clamp.



1 PH 230V 230V 50HZ SINGLE PHASE	IGBT INVERTER TECHNOLOGY IGBT INVERTER TECHNOLOGY	DC DIRECT CURRENT OUTPUT	SPIKE/ GENERATOR SAFE	VRD VOLTAGE REDUCTION DEVICE	CC CONSTANT CURRENT
IPS INTELLIGENT PROTECTION SYSTEM	IP23 CORROSION & SALT SPRAY RESISTANT	LIFT TIG (OPTIONAL TORCH)	POWER FACTOR CORRECTION	MULTI VOLTAGE 110 - 230V	10A PLUG

ADVANCEARC 165





DIMENSIONS (LxWxH)	WEIGHT	INPUT POWER SUPPLY	INPUT POWER SUPPLY TOLERANCE	MAXIMUM INPUT CURRENT	GENERATOR CAPACITY	MMA CURRENT OUTPUT	MMA O/C VOLTAGE	MMA DUTY CYCLE	LIFT TIG CURRENT OUTPUT	LIFT TIG DUTY CYCLE	INSULATION CLASS
390 x 146 x 278mm	6.1kg	230V AC 10A 50/60Hz	90 - 275V AC	22.9A	6kVA	10 - 160A	65V/14.5V Limited	160A@20% 135A@60% 105A@100%	10 - 160A	160A@40% 135A@60% 105A@100%	IP23

MMA ROD SIZE	POWER EFFICIENCY	POWER FACTOR	STANDARDS	WARRANTY
1.6 - 4.0mm	85%	0.99	EN60974-1: 2012	36 months* with registration

* 36 Month Warranty only with online registration of product - www.strata.co.nz

MMA (STICK) WELDING ACCESSORIES & CONSUMABLES

- Standard
- Optional

ACCESSORY:	EZIARC 165	EZIARC 205	ADVANCEARC 165	ADVANCEARC 205
Arc Leads 	○ AAL1625	○ AAL1625	○ AAL3550	○ AAL3550
Earth Leads 	○ AEL1625	○ AEL1625	○ AEL3550	○ AEL3550
TIG Torch 	● P17V-12-2D	● TWP17V-12-2D	● TWP17V-25-2	● TWP17V-25-2
Argon Regulator 	● GR101AR	● GR101AR	● GR101AR	● GR101AR
Gouging Torch 	-	-	-	-

Flip Front Welding Helmet

AFF1000	Flip Front Helmet (MIG/ARC/Plasma)
---------	------------------------------------



SV3000



DW7000 comes with battery powered air respirator.



SV4000



DW4000

Automatic Welding Helmets

- Variable Shade • Complete with batteries ready to go
- Suitable for automotive DIY and industrial use.

SV3000	Auto Welding Helmet, Shade 9 - 13 + Grind Function (MIG/TIG/MMA/Plasma)
SV4000	Auto Welding Helmet, Shade 4 - 13 + Grind Function (MIG/TIG/MMA/Plasma)
DW4000	Auto Welding Helmet, Shade 9 - 13 + Flip Front (MIG/TIG/MMA/Plasma)
DW7000	Auto Welding Helmet, Shade 9 - 13 + PAPR Air Respirator (MIG/TIG/MMA/Plasma)



Black/Gold Welders Gloves

- Fully lined • One piece back • Special "comfort fit".

AWG01	Black/Gold Gloves - Pair
-------	--------------------------

Red/Black Premium Welders Gloves

- Fully lined • Premium quality leather
- Reinforced palm • Special "comfort fit".

AWG02	Red/Gold Gloves - Pair
-------	------------------------

TIG Welders Gloves

- Specially designed for TIG welding
- Fine, hardwearing quality leather.

TWG20	TIG Welding Gloves - Pair
-------	---------------------------

Welding Magnets

WMG03	3" Welding Magnet
WMG05	5" Welding Magnet

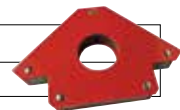

Chipping Hammer

- Heavy duty chipping hammer for the trade

SPCH	Spring Handle Chipping Hammer
------	-------------------------------



MMA Welding Electrodes

HYU21675	2.6mm 6013 General Purpose Electrodes - 5kg
HYU21676	3.2mm 6013 General Purpose Electrodes - 5kg
HYU21677	2.6mm 7018 Low Hydrogen Electrodes - 5kg
HYU21678	3.2mm 7018 Low Hydrogen Electrodes - 5kg